

Dynaflor® HS Horizontal Multistage Pumps

Model Numbers: **HS50-05, HS50-06,
HS60-06 & HS60-08**

DEPEND ON
DAVEY

WATER PRODUCTS



TRANSFER PUMPS

PRODUCT DESCRIPTION

Robust & compact, 3 or 4 stage centrifugal pumps with corrosion resistant componentry and driven by a TEFC motor. Designed for total head duties to 50 m and flows to 110lpm.

APPLICATIONS

Ideal for pumping clean, non-volatile liquids without fibres or solids in such applications as:-

- Household supply
- Irrigation
- Water transfer
- Washing systems
- Pressure Boosting

DESIGN FEATURES

PUMP

3 or 4 stage (impeller) design
Unique floating impeller neckrings
Closed vane impellers - "half blind" design
Stainless steel pump shaft
304 stainless steel casing
In-built & removable inlet check valve
Mechanical shaft seal
Oring casing seal

MOTOR

Davey manufactured TEFC with IP55 enclosure
Class F insulation
Permanently split capacitor design
Double contact C3-HTG sealed bearings
In-built thermal overload protection
Plastic feet on motor shell
Heavy duty cast aluminium lantern bracket & drive end endshield
"Plug & Play" power lead

BENEFITS

- Unique floating neckrings provide outstanding efficiency without compromising grit handling.
- "Half blind" impellers maximise performance and help improve waterway clearances to reduce impeller blockages.
- Manufactured from quality corrosion resistant materials.
- TEFC motor corrosion resistant and protected against entry of dust and dirt.
- Motor and pump designed for frequent starts.
- Quick and easy installation.
- Low maintenance.
- Easy to service if required.
- Low pressure loss through removable in-built check valve.
- "Plug & Play" power lead allows easy system upgrade to an automatic water pressure system.

OPERATING LIMITS

Capacities to	110lpm
Maximum total head	50m
Maximum casing pressure	1000kPa
Maximum suction head	6m
Maximum ambient temperature	50°C
Maximum water temperature	50°C
Minimum water temperature	1°C

TECHNICAL SPECIFICATIONS

MATERIALS OF CONSTRUCTION

PART	MATERIAL
Impellers	Glass filled polycarbonate
Lock nut	304 stainless steel
Pump casing	304 stainless steel
Pump backplate	304 stainless steel
Pump shaft	303 stainless steel
Neckrings	Polypropylene
Seal ring (stationary)	Ceramic
Seal ring (rotating)	Carbon (synthetic)
Seal spring	304 stainless steel
Orings	Nitrile rubber
Stage body	Glass filled noryl
Suction check valve	
Body	Polypropylene
Spring	304SS
Seal	Nitrile
Stage spacer	Glass filled nylon (3 stage models)
Priming plug	Glass filled noryl
Motor shell	Marine grade aluminium
Lantern/DE endshield	Marine grade aluminium
Shell & Lantern finish	Baked polyester

HYDRAULIC PERFORMANCE

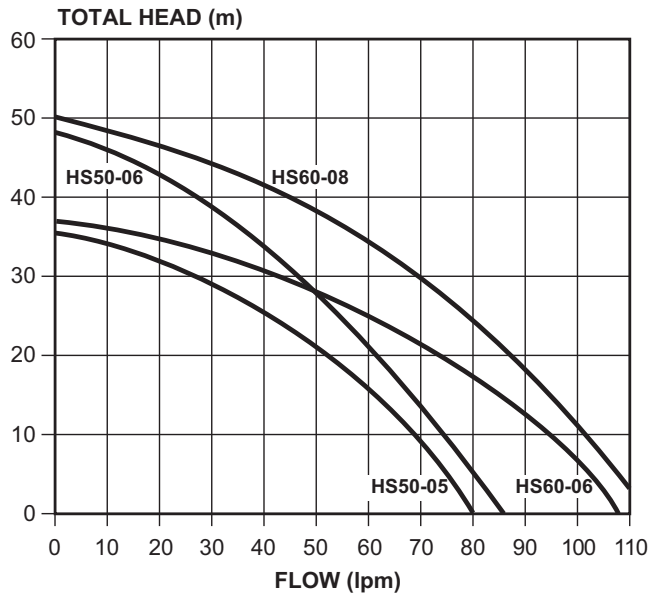

ELECTRICAL DATA

	HS50-05	HS50-06	HS60-06	HS60-08
Supply voltage	220-240V			
Supply frequency	50Hz			
Full load current	3.2A	3.8A	3.5A	4.9A
Locked rotor current	12A	12A	12A	18A
Input power (P ₁)	.74kW	.89kW	.82kW	1.1kW
Output power (P ₂)	.53kW	.6kW	.57kW	.76kW
Enclosure class	IP55			
Insulation class	Class F			
Starting	P.S.C.			

DIMENSIONS

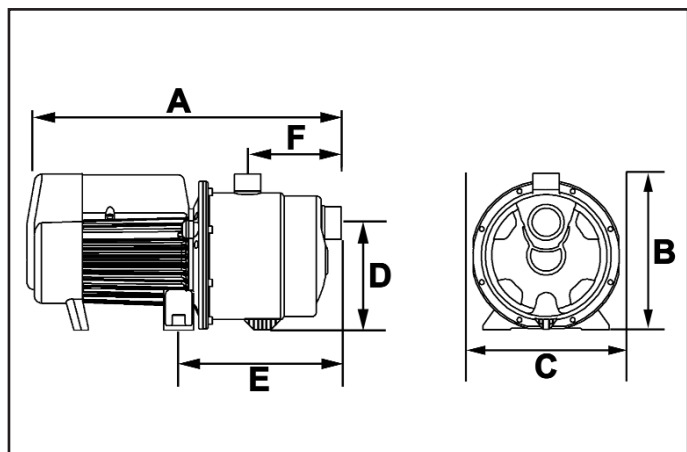

Model	A	B	C	D	E	F	Mounting Holes Dia.	Inlet BSP	Outlet BSP	Net Weight kg
HS50-05	405	212	205	145	222	126	10 @ 140 centres	1 1/4" F	1" F	8.9
HS50-06	405	212	205	145	222	126				8.8
HS50-06	405	212	205	145	222	126				8.9
HS50-06	430	212	205	145	222	126				10.3

All dimensions in mm unless otherwise stated.

INSTALLATION & PRIMING

- Installations with suction lift require a good quality foot valve to avoid loss of prime - remove in-built check valve.
- To prime, fill pump body and suction line through priming plug hole located above suction inlet and replace plug.

This literature is not a complete guide to product usage. Further information is available from your Davey dealer, Davey Customer Service Centre and from the relevant product Installation and Operating Instructions. This data sheet must be read in conjunction with the relevant product Installation and Operating Instructions and all applicable statutory requirements. Product specifications may change without notice. © Davey and Dynaflo are registered trademarks of Davey Products Pty Ltd. © Davey Products Pty Ltd 2004.



DEPEND ON
DAVEY

WATER PRODUCTS

Davey Products Pty Ltd

Member of the GUD Holdings Ltd Group
ABN 18 066 327 517
Head Office and Manufacturing
 6 Lakeview Drive,
 Scoresby, Australia 3179
 Ph: +61 3 9730 9222
 Fax: +61 3 9753 4100
 Website: www.davey.com.au
Customer Service Centre
 Ph: 1300 367 866
 Fax: 1300 369 119
 E-mail: sales@davey.com.au
Interstate Offices
 Sydney - Brisbane - Adelaide
 Perth - Townsville

International

6 Lakeview Drive,
 Scoresby, Australia 3179
 Ph: +61 3 9730 9121
 Fax: +61 3 9753 4248
 E-mail: export@davey.com.au

Germany

Kantstrasse 47,
 04275 Leipzig
 Ph: +49 341 301 0412
 Fax: +49 341 301 0413
 E-mail: akrenz@daveyeurope.com

New Zealand

2 Rothwell Avenue,
 North Harbour, Auckland 1330
 Ph: +64 9 914 3680
 Fax: +64 9 914 3685
 Website: www.daveynz.co.nz
 E-mail: sales@daveynz.co.nz

USA

Davey Pumps Inc.
 1005 N. Commons Drive
 Aurora, Illinois 60504
 Ph: +1 630 898 6976
 Fax: +1 630 851 7744
 Website: www.daveyusa.com
 E-mail: sales@daveyusa.com